

### DESCRIPTION

Plunger Pumps are designed for high-pressure industrial washing applications. They are constructed of castiron bodies and feature a forged brass head with a threaded style sight glass in the rear cover made of metal. Internal components include special solid ceramic plungers for long life and durability. Oversized premium tapered roller bearings and the precision supports assure proper shaft alignment and maximum life. Valve cages of special designed Ultra-Form provide positive seating and extended life. Two-piece connecting rods are bronze material oversized for strength and load disbursement. These pumps are designed for belt drive systems, with a 35mm solid crankshaft.

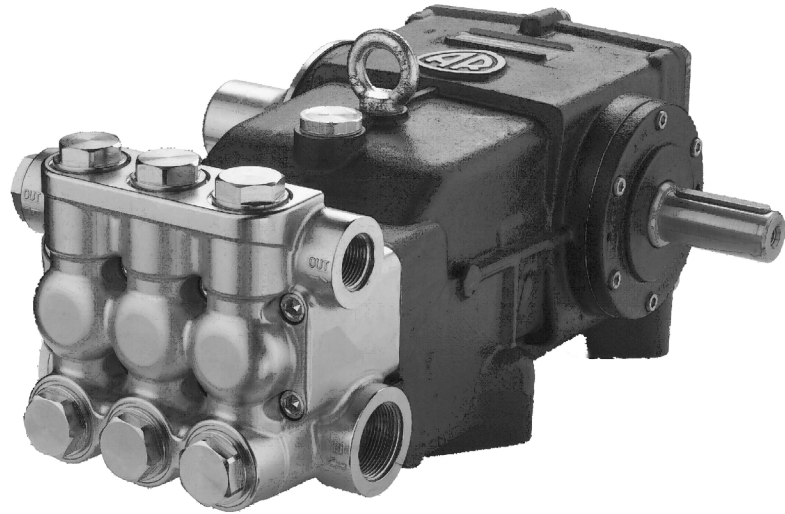

### SPECIFICATIONS

MAX GPM .....	36	MAX LMP .....	135
MAX PSI.....	1450	MAX BAR .....	100
POWER EBHP .....	36	BORE DIA. MM.....	40
STROKE MM.....	48	WEIGHT LBS.....	190
MAX TEMP .....	140°	OIL CAPACITY.....	137oz
INLET THREAD .....	1-1/2" F	DISCHARGE THREAD .....	1" F

### DIMENSIONS

RTF

N version  
Solid shaft pump 35mm

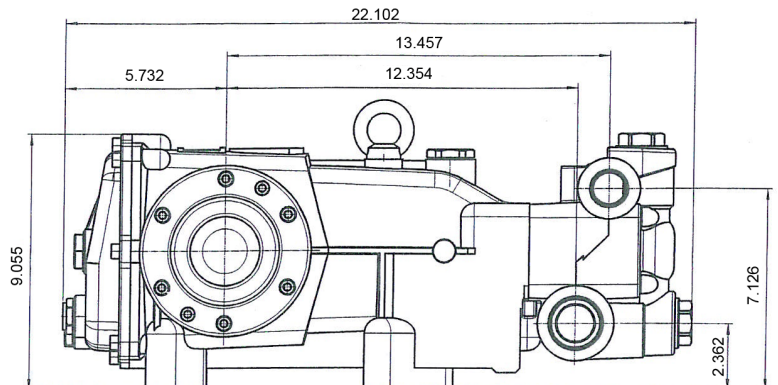
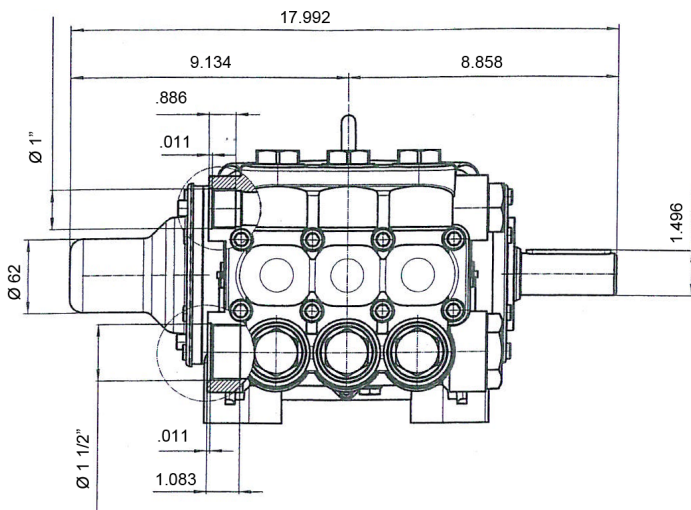

## SPECIAL FEATURES

### WET END

- **Manifold:**
  - **Forged Brass:** Strength and no porosity – long life. Higher hydrostatic pressures – safety, performance.
  - **Inlet and Discharge Ports:** Heavy bosses for added strength.
  - **Offset Discharge Ports:** High efficiency, smooth flow.
  - **Bolts:** Eight bolts, 12mm, grade 8.8.
- **Valves:**
  - **Ultra Form Cages:** Durable, strength, and long life.
  - **Poppets, Seat and Spring:** 303 and 400 series stainless steel.
  - **Valve Caps:** Machined
- **Packing and Plungers:**
  - **High Pressure Packing:** "V" style chevron style seal with a rear support seal.
  - **Low Pressure Seals:** W-2 style seal with a support rod whipper ring, Buna-N for a good positive seat.
  - **Support and Guides:** Machined brass, 2-piece construction to assure proper plunger alignment and to maximize packing and seal life.
  - **Plungers:** Are a special aluminum oxide blend, solid ceramic for long life, strong durability and more resilient. The plungers utilize a locating stop on the plunger rod and a 8mm Ø retaining stud with a retaining cap.

### DRIVE END

- **Bearings:** Oversized for maximum life and load disbursement
- **Bearing Support:** Precision cast and machined to assure concentricity and alignment.
- **Crankcase:** Precision cast, large cross head for strength, large cooling fins.
- **Rear Cover:** Precision die-cast, O-ring sealed and metal construction sight glass for positive sealing and locking.

- **Plunger Rods:** Stainless steel construction for strength (no plating to scrape off), back-up and O-ring plunger sealing system.
- **Rod Pins:** Precision ground and hardened steel, oversized for load disbursement.
- **Connecting Rods:** Heavy 2-piece bronze, oversized for maximum strength, load disbursement, and life. Heavy pin area construction, for added load strength.
- **Crankshaft:** Machined, precision ground and hardened for extremely long life and durability.
- **Oil Seals and O-rings:** All are constructed of Buna-N rubber. The O-rings have stainless steel garter springs to assure constant tension on the sealing surface.
- **Oil Capacity:** 137 oz.

### EXTRA FEATURES

- **Dyno Proven:** All pumps are dyno tested to assure the theoretical design meets the actual design.
- **Valve Design:** Each pump series has a valve design that optimizes its highest efficiency.
- **Wet End Repair:** Very simple no special tools required.
- **Design:** Using advanced fluid handling design programs. Overall pump efficiency is increased.