

RYOBI
TRIMMER

MODEL NO. R70

REPAIR SHEET

TRIMMER

R-70

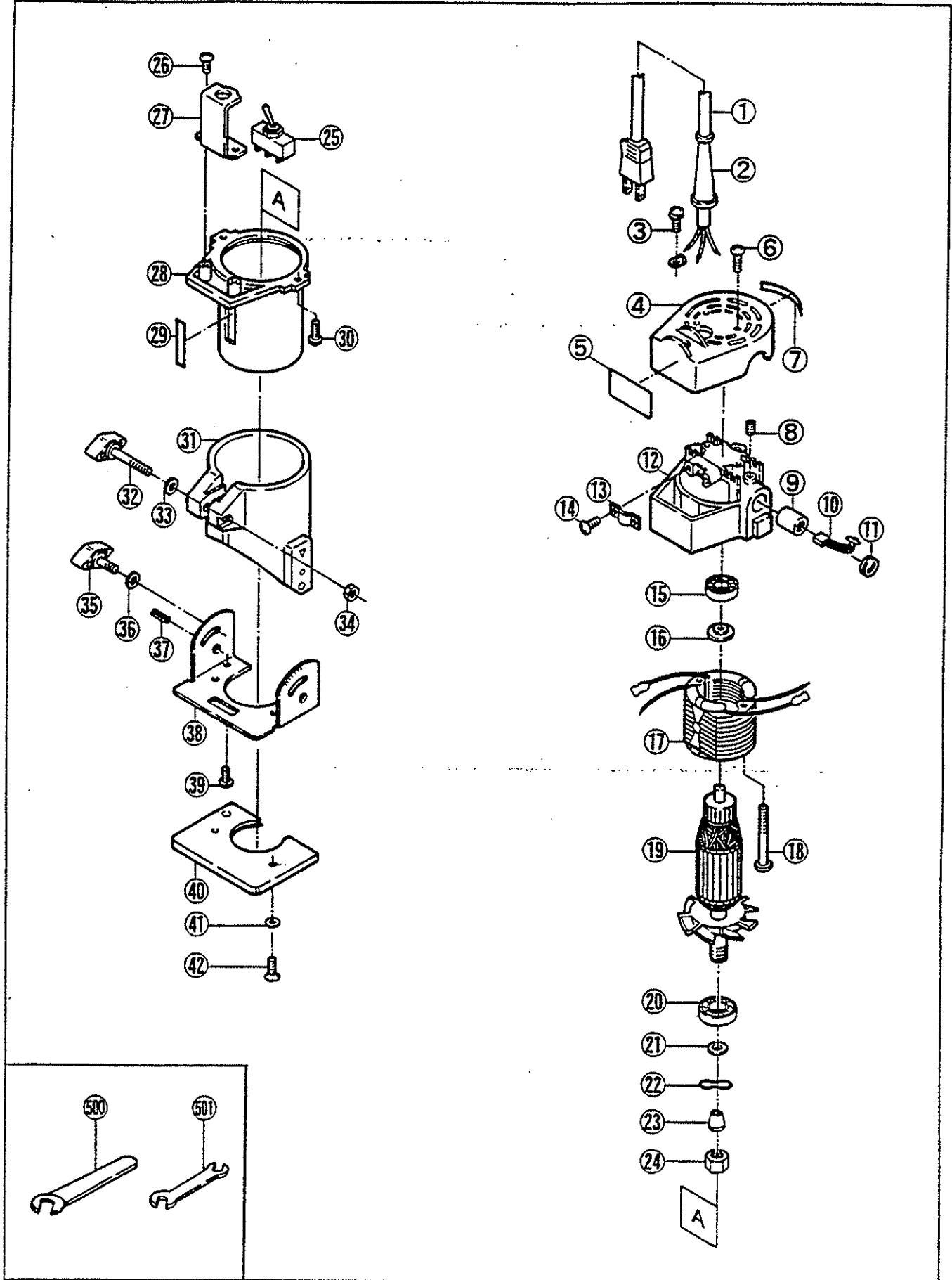

PARTS LIST FOR AFTER SALES SERVICE MODEL R70

I	PART NO.	DESCRIPTION	QTY	REF	PART NO.	DESCRIPTION	QTY
1	6520232	CORD ASSY AWG#18X3X2	1	26	9040412	TAPPING SCREW (S) M4X12	2
2	6560101	CORD HOLDER	1	27	6590132	BRACKET	1
3	9020412	PHILLIPS PAN SCREW M4X12	1	28	6800399	MOTOR HOUSING	1
4	6800404	TAIL COVER	1	29	6920223	SCALE	1
5	6920222	"RYOBI" MARK	1	30	9040412	TAPPING SCREW (S) M4X12	2
6	9040412	TAPPING SCREW (S) M4X12	2	31	6850131	BASE	1
7	6912868	NAME PLATE	1	32	6130391	WING BOLT M6X35	1
8	9280506	CLAMP SCREW M5X6	2	33	9570600	WASHER	1
9	6570002	BRUSH HOLDER	2	34	9300600	HEX NUT M6	1
10	6540033	CARBON BRUSH SET	1	35	6130392	WING BOLT M5X10	2
11	6570070	BRUSH CAP	2	36	9570500	WASHER	2
12	6320075	BRACKET	1	37	9406012	SPRING PIN	2
13	6560055	CORD CLAMP	1	38	6850134	BRACKET	1
14	9040414	TAPPING SCREW (S) M4X14	2	39	9040408	TAPPING SCREW (S) M4X8	1
15	9840627	BALL BEARING #627LLB	1	40	6360066	BASE PLATE	1
16	6150564	BEARING COLLAR	1	41	9570400	WASHER	2
17	6500429	FIELD COIL	1	42	6131084	TRUSS TAPPING SCREW M4X8	2
18	9020455	PHILLIPS PAN SCREW M4X55	2	---	6560002	CONNECTOR	2
19	6030456	ARMATURE	1	---	6560008	TERMINAL	1
20	969235004	BALL BEARING #6002LLB	1	---	6560020	TERMINAL	2
21	6900670	THRUST WASHER	1				
22	3643200	WAVE WASHER	1				
23	6940139	COLLET SLEEVE 1/4"	1				
STANDARD ACCESSORIES							
24	6130302	COLLET NUT	1	500	6240533	SINGLE-END WRENCH 17	1
25	6550016	TOGGLE SWITCH	1	501	6240623	OPEN-END WRENCH	1

SERVICE NOTES: