

XWT / XWF / XWL / XWLA - Triplex Plunger Pumps

FEATURING

MANIFOLD: High strength forged brass for long term use.

BOLTS: Eight 10mm grade 8.8.

PLUNGERS: A special thick solid ceramic for long life, strong durability and more resilience.

CRANKCASE: Precision die-cast, large cooling fins and anodized for maximum heat dissipation. Bayonet style sight glass located in the rear and side cover, fill and side and bottom drain plugs.

BEARINGS: Oversized premium tapered roller bearing for maximum life and load disbursement.

BEARING SUPPORT: Precision die-cast and machined to assure concentricity, alignment and strength.

VALVES, SEATS, AND SPRINGS: Stainless steel with specially designed Ultra Form cages to provide long life and positive seating.

SEALS AND U-PACKING: Continuously lubricating for extended life. Triple lip oil seal for assured crankcase seal.

PLUNGER RODS: High strength stainless steel, for heavy duty use.

CONNECTING RODS: Two-piece special alloy aluminum based material, oversized for maximum strength, load disbursement, and long life. Heavy pin area construction, for added load strength.

DIMENSIONS

XWT / XWF / XWL / XWLA N version
Solid shaft pump ø 24 mm

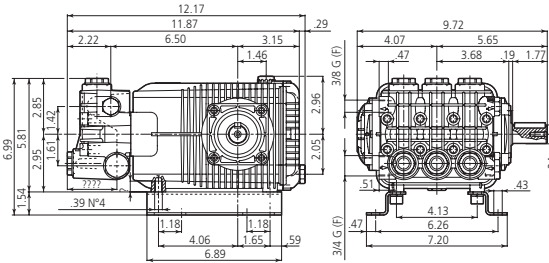

**PATENTED
VALVE CAP
DESIGN.**

XWT 500 RPM N VERSION 24MM SOLID SHAFT

MODEL	MAX GPM	MAX L/MIN	MAX PSI	MAX BAR	POWER EBHP	BORE DIA MM	STROKE MM	CRANKSHAFT ID STAMP	WEIGHT LBS.
XWT21.20N	5.55	21	2900	200	11	28	19.8	1	34

XWF 1000 RPM N VERSION 24MM SOLID SHAFT

XWF26.20N	6.87	26	2900	200	13	28	15	8	34
XWF30.20N	7.92	30	2900	200	15	28	17.2	2	34
XWF36.17N	9.51	36	2500	170	15	28	19.8	1	34

XWL 1450 RPM N VERSION 24MM SOLID SHAFT

XWL41.21N	10.8	41	3000	200	22.2	28	17.2	2	34
XWL42.15N	11.09	42	2200	150	16	28	17.2	2	34

XWLA 1750 RPM N VERSION 24MM SOLID SHAFT

XWLA13G15N	13	49	1450	100	13	28	17.2	2	34
------------	----	----	------	-----	----	----	------	---	----

Oil Capacity = 32 oz

Maximum Fluid Temperature = 140° F

Inlet Thread = 3/4" F

Discharge Thread = 3/8" F

RAIL KITS

AR 2748 1-1/4"

SPECIAL NOTE: Use AR64516 Oil. First change oil after 50 hours of use. Then every 500 hours. This oil is specially formulated to provide correct lubrication properties for our pumps. **No** other oil is factory approved for these pumps.

*Available upon special request (non-stock item)