

Repair Kits

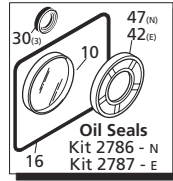
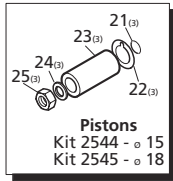
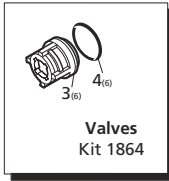

Special Parts / Kits

Code	Description	Qty.
2776	Viton water seals $\varnothing$ 15	1
2777	Viton water seals $\varnothing$ 18	1
2729	Rail Kit - 5/8" - 2 Rails & 4 Bolts	1
2633	Rail Kit - 1-3/4" - 2 Rails & 4 Bolts	1
2633H	Rail Kit - 2-5/8" - 2 Rails & 4 Bolts	1

Pos	Code	Description	Qty.	Pos	Code	Description	Qty.
1	960160	O-Ring $\varnothing$ 17.86x2.62	6	31	1780100	Rear piston guide $\varnothing$ 15 $\square$	3
2	1260162	Valve cap	6	32	1780120	Rear piston guide $\varnothing$ 18 $\bullet$	3
3	1260162T	Valve Cap 1/4" threaded	1	33	770260	O-Ring $\varnothing$ 23.52x1.78	3
4	1269050	Complete valve	6	34	1260440	Low pressure seal $\varnothing$ 15 $\square$	3
5	880830	O-Ring $\varnothing$ 15.54x2.62	6	35	1260450	Low pressure seal $\varnothing$ 18 $\bullet$	3
6	620301	Plug 1/8" G	1	36	820361	Plug 1/2" G	1
7	1780130	Support ring $\varnothing$ 15 $\square$	3	37	180101	O-Ring $\varnothing$ 17.5x2	1
8	1780140	Support ring $\varnothing$ 18 $\bullet$	3	38	1780020	Pump head	1
9	1260130	High pressure packing $\varnothing$ 15 $\square$	3	39	1381550	Washer	8
10	1260220	High pressure packing $\varnothing$ 18 $\bullet$	3	40	1322730	Head bolt M6x60	8
11	1780090	Piston guide $\varnothing$ 15 $\square$	3	41	1321190	Bearing	1
12	1780110	Piston guide $\varnothing$ 18 $\bullet$	3	42	1321080	Snap ring	1
13	1780010	Pump body	1	43	480671	Oil seal	1
14	1266740	Cap	1	44	1780150	Crankshaft 24mm	1
15	1260790	Circlip $\varnothing$ 152	1	45	1780170	Crankshaft 24mm	1
16	1780550	Snap ring	1	46	1780180	Crankshaft 24mm	1
17	1780490	Bearing	1	47	1780820	Crankshaft $\varnothing$ 3/4"	1
18	880130	Vented oil cap	1	48	1781050	Hollow shaft $\varnothing$ 5/8"	1
19	1780050	Piston pin	3	49	1780990	Hollow shaft $\varnothing$ 5/8"	1
20	1780510	Gasket	1	50	1781180	Hollow shaft $\varnothing$ 5/8"	1
21	1200430	Bolt M6x16	6	51	1780290	Hollow shaft $\varnothing$ 1-1/8"	1
22	1789010	Complete cover	1	52	1780300	Hollow shaft $\varnothing$ 1-1/8"	1
23	1780040	Con rod	3	53	1780950	Hollow shaft $\varnothing$ 1-1/8"	1
24	1780060	Guiding piston	3	54	1380520	Key	1
25	480480	O-Ring $\varnothing$ 4.48x1.78	3	55	1260750	Oil seal	1
26	1260091	Washer (slinger)	3	56	620610	Bolt M8x30	4
27	1780070	Plunger $\varnothing$ 15 $\square$	3	57	1780910	Electric motor flange - F33	1
28	1780080	Plunger $\varnothing$ 18 $\bullet$	3	58	1789201	Complete pump head $\varnothing$ 15 $\square$	1
29	1260100	Piston washer	3	59	1789202	Complete pump head $\varnothing$ 18 $\bullet$	1
30	1260110	Nut M8	3	60	1591	Motor Flange	1
	1380141	Rail 5/8" (N Version Only)	2	61	180030	Bolt M8x20	4
	Z-Bracket 1-3/4"	(N Version Only)	2	62	1260250	Oil sight glass	1
	Z-Bracket	(N Version Only)	2	63	1260430	Snap ring	1
	740290	O-Ring $\varnothing$ 14x1.78	3	64	1780690	Contrast disc	1
	1980740	Plug 3/8" G	3	65	1140450	O-Ring $\varnothing$ 20.24x2.62	1
	1260470	Bolt M8x10	4				
	1260460	Oil seal	3				

Pos	Code	Description	Qty.
	AR64516	Oil	1
		<i>OIL CAPACITY - 14.5 OZ</i>	

Legend		
$\varnothing$ 15	$\varnothing$ 15	$\varnothing$ 18
For $\square$	For $\blacktriangle$	For $\bullet$
XMA3G25	XMA3.5G22	XMA4G20
	XMA3.5G25	
For $\blacksquare$	For $\blacklozenge$	
XMA2G22	XMA3.5G22 (3/4" shaft)	
For $\square$	For $\nabla$	
XMA2.5G18	XMA3G18	

