

DESCRIPTION

Plunger Pumps are designed for high-pressure industrial washing applications. They are constructed of cast iron bodies and feature a forged brass head with a threaded style sight glass in the rear cover made of metal. Internal components include special solid ceramic plungers for long life and durability. Oversized premium tapered roller bearings and the precision supports assure proper shaft alignment and maximum life. Valve cages of special designed Ultra-Form provide positive seating and extended life. Two-piece connecting rods are bronze material oversized for strength and load disbursement. These pumps are designed for belt drive systems, with a 35mm solid crankshaft.

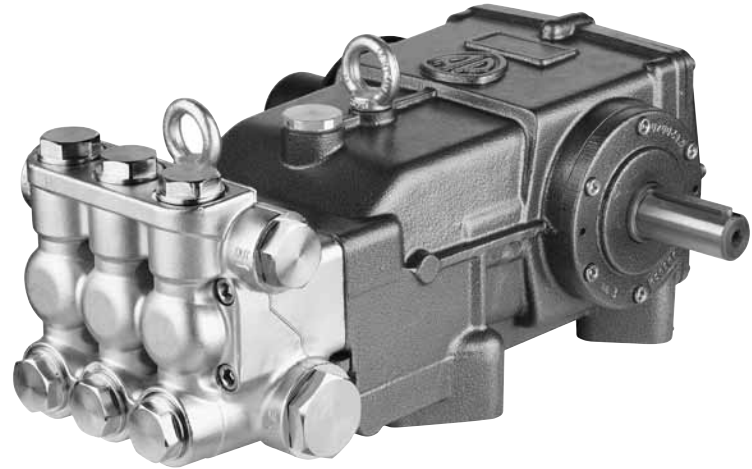

SPECIFICATIONS

| | | | |
|--------------------|----------|------------------------|-------|
| MAX GPM | 18.5 | MAX LMP | 70 |
| MAX PSI | 4000 | MAX BAR | 275 |
| POWER EBHP | 50.8 | BORE DIA. MM | 25 |
| STROKE MM | 48 | WEIGHT LBS | 198 |
| MAX TEMP | 140° | OIL CAPACITY | 137oz |
| INLET THREAD | 1-1/2" F | DISCHARGE THREAD | 1" F |

DIMENSIONS

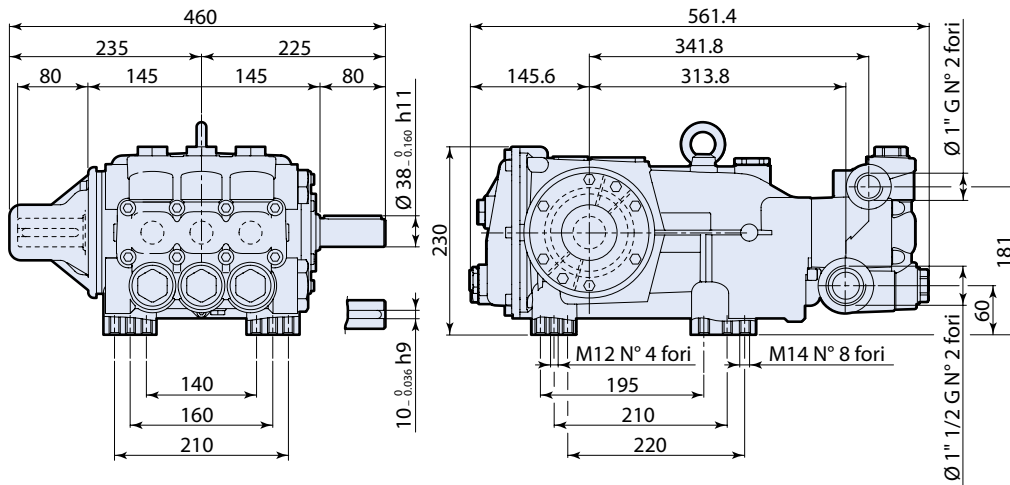

Measurements are - mm

FEATURING

Manifold: High strength forged brass for long term use.

Bolts: Eight 8mm grade 8.8.

Plungers: Are a special aluminum oxide blend, solid ceramic for long life, strong durability and more resilient.

Valves: Stainless steel with specially designed Ultra Form cages to provide long life and positive seating.

Seals: High pressure packing "V" style (D-1) Buna-N strong

and tightens under load, and low pressure seal "U" cup double lip Buna-N for a good positive seat.

Drive End: Oversized bearings for maximum life and load disbursement.

Crankshaft: Precision die-cast, large cross head for strength, large cooling fins and anodized (for maximum heat dissipation).